

6. Features

- Mirror your PC's desktop to your interactive intelligent panel display by connecting the transmitter to your PC and running the Instaclick.
- Support synchronization of audio and video.
- Multiple transmitters are in a ready state quickly switch by pressing the button on the transmitter.

7. Key Specifications

- Operating systems supported: Windows7/8/8.1/10; OSX 10.9/ 10.10/10.11
- Operation frequency: 2432MHz, 5180 MHz
- Input power: 5V-DC
- Overall power consumption: 2.5 W
- Overall dimensions (LxWxD): 77 mm×178.7 mm×21.3 mm

8. Packing List

Wireless transmitter — 1 pcs
USB receiver — 1 pcs
Operating instruction — 1 pcs

9. Warning

This device complies with Part 15 of the FCC Rules. Operation is subject to the following two conditions: (1) this device may not cause harmful interference, and (2) this device must accept any interference received, including interference that may cause undesired operation.

Changes or modifications not expressly approved by the party responsible for compliance could void the user's authority to operate the equipment.

NOTE: This equipment has been tested and found to comply with the limits for a Class B digital device, pursuant to Part 15 of the FCC Rules. These limits are designed to provide reasonable

protection against harmful interference in a residential installation. This equipment generates, uses and can radiate radio frequency energy and, if not installed and used in accordance with the instructions, may cause harmful interference to radio communications. However, there is no guarantee that interference will not occur in a particular installation. If this equipment does cause harmful interference to radio or television reception, which can be determined by turning the equipment off and on, the user is encouraged to try to correct the interference by one or more of the following measures:

- Reorient or relocate the receiving antenna.
- Increase the separation between the equipment and receiver.
- Connect the equipment into an outlet on a circuit different from that to which the receiver is connected.
- Consult the dealer or an experienced radio/TV technician for help.

The device for operation in the 5180 MHz is only for indoor use to reduce the potential for harmful interference to co-channel mobile satellite systems.

10. RF Exposure Statement

FCC RF Radiation Exposure and SAR Statements SAR Statement The Wireless Screen Mirroring has been tested for body-worn Specific Absorption Rate (SAR) compliance. The FCC has established detailed SAR requirements and has established that these requirements. RF Exposure Information The radio module has been evaluated under FCC Bulletin OET 65C (01-01) and found to be compliant to the requirements as set forth in CFR 47 Sections, 2.1093, and 15.247 (b) (4) addressing RF Exposure from radio frequency devices. This model meets the applicable government requirements for exposure to radio frequency waves. The highest SAR level measured for this device was 0.085 W/kg.



Wireless Screen Share User Manual

Model: AC-INSTACLICK



1. Safety Warnings and Precautions

Before using and operating this device, please read thoroughly and comply with the following precautions in order to prevent accidents or mal-operations.

Operating Environment

Do not charge or use the device in dusty or wet conditions, to prevent internal circuit failure. Keep the device away from heat sources such as an electric heater.

Safety Precaution for Children

This device and its parts may contain some small components, so keep the product out of reach of children to prevent accidents.

Water Precaution

This device is not water-resistant. Keep it dry.

Maintenance

Please contact professional service personnel for maintenance services. Do not insert any sharp or pointed object into the device. Prevent the device from falls and collisions with other objects, which may cause damages.

2. Statements

- Intellectual property right statement: The hardware design and software of this product are covered by the patents. Anyone who reproduces this product or the content of the instruction without the authorization of the Company shall assume legal liabilities.
- This instruction is provided for reference only, and the functions shown in the manual may differ from the actual functions of the product the customers actually purchase and receive.
- The picture is for reference only. Please subject to the actual product. The Company reserves the rights to improve and change the appearance and design of the product without notice.

3. Connection

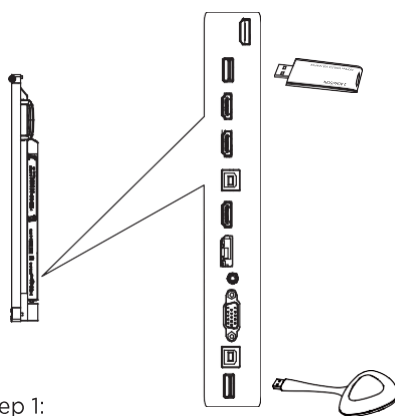

Step 1:
First time use: Connect the transmitter and receiver to the USB ports on your Interactive Flat Panel (IFP) for pairing (after then, there is no need to pair again).
Note: Please make sure that the pairing is based on the figure shown above.

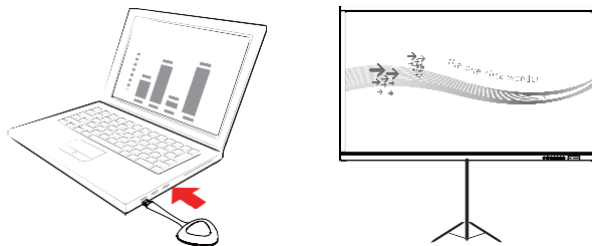

Step 2:
After pairing, connect the transmitter to a USB port on your PC; click to run the Instaclick (this is required for the first time use; after then there is no need to operate again).

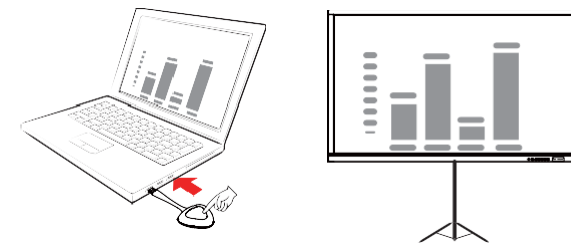

Step 3:
Press the button on the transmitter by following the prompts displayed on your PC to implement screen mirroring.
Notice:
The use of wireless transmitter of your computer, should be able to connect wifi, if not, the wireless transmitter could not work normally.

4. Indicators Status Descriptions

- Blinking: The transmitter is connecting to the interactive intelligent panel display.
- Steady on: The transmitter is connected to the interactive intelligent panel display and the screening mirroring is set up.
- Low brightness: Mirroring

5. Basic Troubleshooting

When the systems cannot get connected, please troubleshoot as follows:

- Check that the Instaclick runs properly and is activate on your PC.
- Check that the receiver is correctly connected to the interactive intelligent panel display.
- Pair the screen mirroring devices again and restart the interactive intelligent panel display.
- Check the hotspot of the IFP when the Instaclick is unable to connect.
- Check whether your PC supports 5G band WIFI when the Instaclick is unable to connect. If not, switch the hotspot of IFP to 2.4G.